

- Flush dry ceramic sensor
- Ranges from 40 mbar to 60 bar
- Global error < 0,2% F.S.
- High overload capability
- Analog output: 4...20 mA, 2-wire
- Suitable for food- and pharmaceutic industries
-  I M2 EEx ia I
II 1G EEx ia IIC T4/T6
BVS 03 ATEX E 222



Pressure transmitter P 131

Technical data:

Ranges:	0...40 mbar to 0...60 bar
Output signal:	4...20 mA, 2-wire
Global Error:	< 0,2% F.S.
Response time:	200 ms (other available on request)
Supply voltage:	9...32V DC, max. 30 mA (12...30V Ex-version)
Ambient temperature:	-25...80 °C (-25...80 °C at EEx ia IIC T4) (-25...50 °C at EEx ia IIC T6)
Fluid temperature:	-40...100°C (125 °C < 0,5h) (-25...80 °C at EEx ia IIC T4) (-25...50 °C at EEx ia IIC T6)
Thermal drift:	< 0,015%/K (zero) < 0,01%/K (span)
Long-term stability:	< 0,15% F.S. p. a.
Housing:	stainless steel, 1.4571
Sensor:	ceramic AL ₂ O ₃
Electr. connection:	DIN 43650 connector, IP 65 cable 2m/5m, IP 68

Nöding

Meßtechnik

Ranges

range	gauge	absolut	overload (bar)
0...40 mbar ⁽¹⁾	A8		- 0,3 / 4
0...50 mbar ⁽¹⁾	B0		- 0,3 / 4
0...60 mbar*	A9		- 0,3 / 4
0...100 mbar	00		- 0,3 / 4
0...160 mbar	01		- 0,6 / 5
0...200 mbar	B1	B2	- 1 / 6
0...250 mbar	02		- 1 / 6
0...0,4 bar	03		- 1 / 6
0...0,5 bar	B7		- 1 / 6
0...0,6 bar	04	29 ⁽¹⁾	- 1 / 10
0...1 bar	05	30	- 1 / 10
0...1,6 bar	06	31	- 1 / 18
0...2 bar	B3	B4	- 1 / 18
0...2,5 bar	07	32	- 1 / 18
0...4 bar	08	33	- 1 / 25
0...6 bar	09	34	- 1 / 40
0...10 bar	10	35	- 1 / 40
0...16 bar	11	36	- 1 / 40
0...20 bar	B5	B6	- 1 / 40
0...25 bar	12	37	- 1 / 40
0...40 bar	13	38	- 1 / 60
0...60 bar	14	39	- 1 / 100
-100...0 mbar ⁽¹⁾	C4		- 0,3 / 4
-100...100 mbar ⁽¹⁾	C5		- 1 / 6
-200...0 mbar ⁽¹⁾	D2		- 1 / 6
-200...200 mbar ⁽¹⁾	D3		- 1 / 6
-1...1 bar ⁽¹⁾	D6		- 1 / 10
-1...3 bar ⁽¹⁾	D8		- 1 / 25
-1...5 bar ⁽¹⁾	D9		- 1 / 40
-1...9 bar ⁽¹⁾	E1		- 1 / 40
-1...15 bar ⁽¹⁾	E2		- 1 / 40

* Global error 0,5% F.S.

⁽¹⁾ not for G 1 A

Ordering code

Output signal

- 1 0...10V 3-wire
- 4 4...20 mA 2-wire
- E 4...20 mA 2-wire
- M 4...20 mA 2-wire

- II 1G EEx ia IIC T4/T6
- I M2 EEx ia I

Range

See table on the left

99 Special range

Process connection and material

- M Dairy thread ND 25 DIN 11851, 1.4571
- 6 Dairy thread ND 32 DIN 11851, 1.4571
- 7 Dairy thread ND 40 DIN 11851, 1.4571
- K Dairy thread ND 40 aseptic, 1.4571
- N DRD flange ND 65 1.4571
- F G 1 A, 1.4571
- 5 G 1 ½ A, 1.4571
- H Varivent 32/25, 1.4571
- J Varivent 50/40, 1.4571
- L Clamp 1", ND 25...40, 1.4404 (316L)
- 9 Special version

Sensor seal

- 1 FPM (Viton) Standard
- 2 NBR (Nitril)
- 3 EPDM
- 4 Fluor-Silicon
- 5 Kalrez
- 9 Special version

Electrical connection

- 0 5m cable, IP 68
- 1 DIN 43650 connector
- 2 4 pin Binder-plug M18
- 3 4 pin Binder-plug M18, potted electronic
- 4 DIN 43650 connector, potted electronic
- 5 5m cable, IP 68, potted electronic
- 6 2m cable, IP 68, potted electronic
- 7 2m cable, IP 68, potted electronic
- 8 6 pin Mil connector
- 9 Special version

Options

- R Ceramic sensor 99,9% Al₂O₃
- T Minimized case volume
- RT Ceramic sensor 99,9% Al₂O₃ with minimized case volume

P131 -

Dimensions

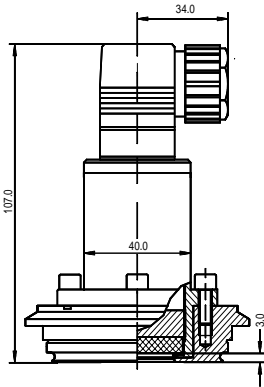

Varivent

Ranges:
from 40 mbar to 40 bar

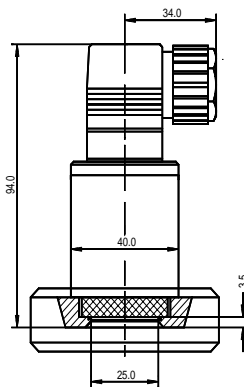

Dairy thread ND 25/32/40

Ranges:
from 40 mbar to 40 bar

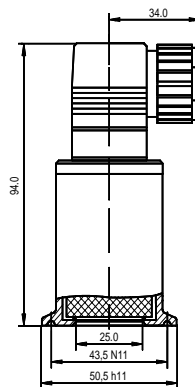

Clamp ND 25/38/40

Ranges:
from 40 mbar to 40 bar

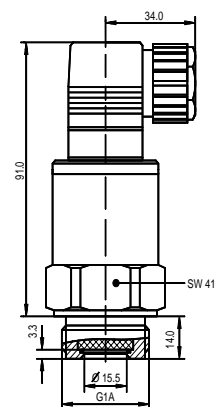

G 1 A

Ranges:
from 60 mbar to 20 bar

Electrical connections

DIN 43650 connector

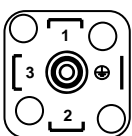

4...20 mA 2-wire
PIN1 Signal +
PIN2 Signal -
PE

Binder M 18 Serie 714 connector



4...20 mA 2-wire
PIN2 Signal +
PIN3 Signal -
PIN4 PE

Cable connection IP 68

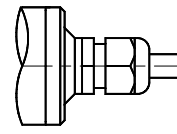

4...20 mA 2-wire
red Signal +
black Signal -
green/yellow PE

Modifications reserved without notice, 02.05