

- 22 mm Ø ideal for 1" pipes
- Ranges from 100 mbar to 20 bar
- Global error < 0,2% F.S.
- Ex II 1G EEx ia IIC T4/T6
- Integrated lightning protection
- Cable according Bg VV-1.12.96-specifications, suitable for food and drinking water
- Optional integrated Pt 100 sensor for temperature measurement



Level transmitter P 135

Technical data:

Ranges:	0...100 mbar to 0...20 bar
Output signal:	4...20 mA, 2-wire
Global error:	< 0,2% F.S.
Response time:	200 ms (other available on request)
Supply voltage:	12...30V DC, max. 30 mA
Ambient temperature:	-25...80 °C (-25...80 °C at EEx ia IIC T4) (-25...50 °C at EEx ia IIC T6)
Thermal drift:	< 0,015%/K F.S.
Housing:	stainless steel, 1.4571, IP 68
Weight of probe:	approx. 0,3 kg
Weight of cable:	0,5 kg / 10m
Electr. connection:	PE cable with pressure compensation capillary and filter

Nöding

Meßtechnik

Ranges

range in bar		range in mH ₂ O		overload (bar)
0...100 mbar	00	0...1 mH ₂ O	50	-0,3/4
0...160 mbar	01	0...1,6 mH ₂ O	51	-1/5
0...200 mbar	B1	0...2 mH ₂ O	W1	-1/5
0...250 mbar	02	0...2,5 mH ₂ O	52	-1/5
0...0,4 bar	03	0...4 mH ₂ O	53	-1/6
0...0,5 bar	B7	0...5 mH ₂ O	W2	-1/6
0...0,6 bar	04	0...6 mH ₂ O	54	-1/10
0...1,0 bar	05	0...10 mH ₂ O	55	-1/10
0...1,6 bar	06	0...16 mH ₂ O	56	-1/15
0...2,0 bar	B3	0...20 mH ₂ O	W3	-1/15
0...2,5 bar	07	0...25 mH ₂ O	57	-1/15
0...4,0 bar	08	0...40 mH ₂ O	58	-1/25
0...5,0 bar	F1			-1/40
0...6,0 bar	09	0...60 mH ₂ O	59	-1/40
0...10 bar	10	0...100 mH ₂ O	60	-1/40
0...16 bar	11	0...160 mH ₂ O	61	-1/40
0...20 bar	B5	0...200 mH ₂ O	W5	-1/40

Ordering code

Output signal

4 4...20 mA 2-wire
 E 4...20 mA 2-Leiter II 1G EEx ia IIC T4/T6T
 4...20 mA 2-wire and Pt 100 sensor 3-wire

Range

See table on the left
 99 special range

Material housing / sensor seal

1 1.4571 / FPM (Viton)
 3 1.4571 / EPDM

Cable cuttable

002 2m cable from 5m to 50m
 005 5m cable only in 5m intervals
 010 10m cable
 050 50m cable from 50m only in
 100 100m cable 10m intervals
 Special lengths quote in meters

Cable material

0 PE cable
 1 FDR 25 cable (Diesel oil resistant)
 2 PUR cable
 3 PTFE (Teflon)

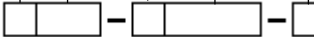
P 135 — 

Dimensions

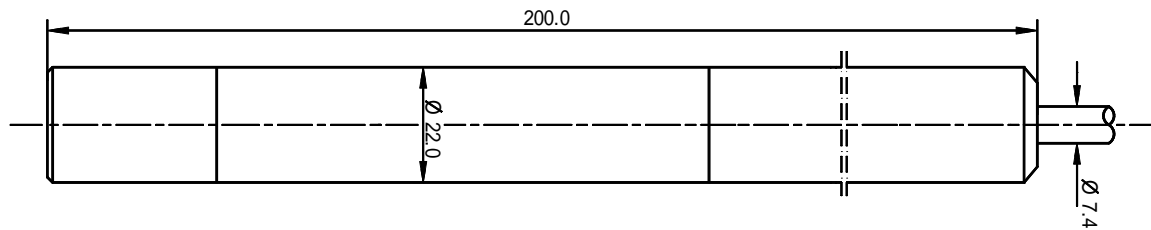

Electrical connections

4...20 mA, 2-wire

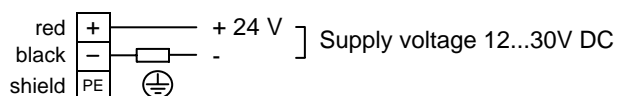

4...20 mA, 2-wire and Pt 100 sensor, 3-wire

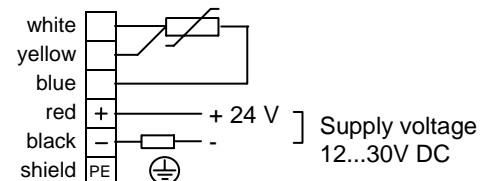

Modifications reserved without notice, 02.05